

## OFFICES FOR LEASE

# 222

**E. HUNTINGTON DR.**  
**MONROVIA**

Partnership. Performance.



Located in the heart of Monrovia on Huntington Drive and right off the 210 Freeway, this beautifully landscaped and high identity professional building features tons of easy access parking, a towering two-story glass atrium entryway, elevators, mature shady trees, and manicured grounds throughout. Suites offer large bay depths, high ceilings and have a combination of open areas, private offices, showroom. Office/Flex/R&D.

Awarded Energy Star label for its operating efficiency.

### Total Building Size

Approximately 122,734 square feet

### Parking

3.5/1000 (Free of charge)

#### Andrew Berk

323.603.5075

[andrew.berk@avisonyoung.com](mailto:andrew.berk@avisonyoung.com)

DRE License #01369568

#### Mark Evanoff

323.851.6666

[markevanoff@avisonyoung.com](mailto:markevanoff@avisonyoung.com)

DRE License #00898650

### Space Available

**From 3,500 up to 32,000 SF**

Suite 104: ± 4,081 RSF\*\*

Suite 111: ± 8,903 RSF\*\*

Suite 118: ±11,238 RSF

Suite 206: ± 3,578 RSF

Suite 221: ± 4,591 RSF

\*\*combined for ± 12,984 RSF\*\*

### Lease Rate:

\$2.35 per RSF, per month, FSG





Partnership. Performance.

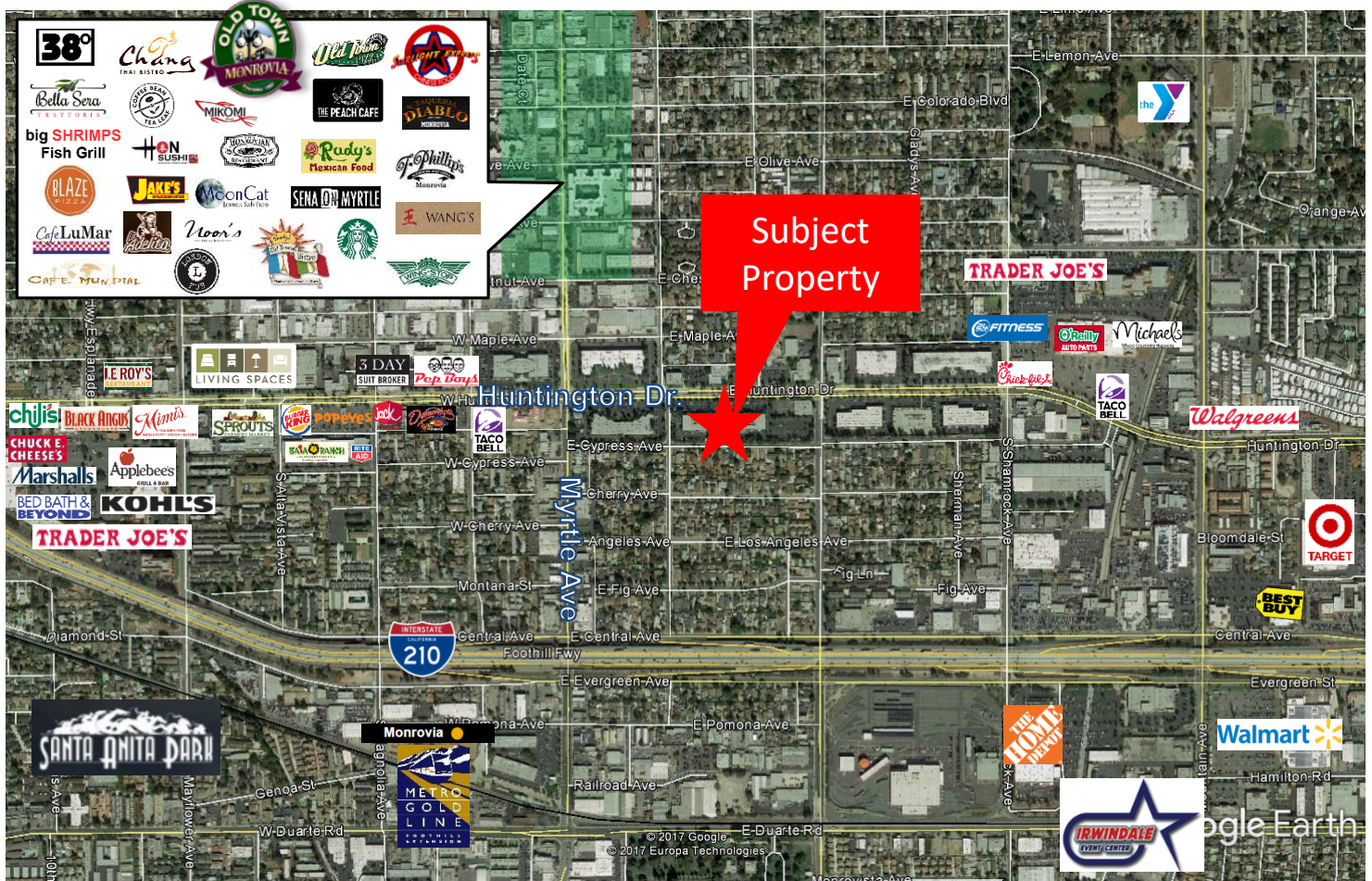

### Notable Monrovia Tenants & Amenities

- Ducommun
- WorleyParsons
- Oracle
- AeroVironment
- Parasoft
- Tanner Research
- Green Dot
- City of Hope
- ITT (Deep Space)
- Trader Joe's HQ

#### Andrew Berk

323.603.5075  
andrew.berk@avisonyoung.com  
DRE License #01369568

#### Mark Evanoff

323.851.6666  
mark.evanoff@avisonyoung.com  
DRE License #00898650



Partnership. Performance.

**GROUND FLOOR PLAN**

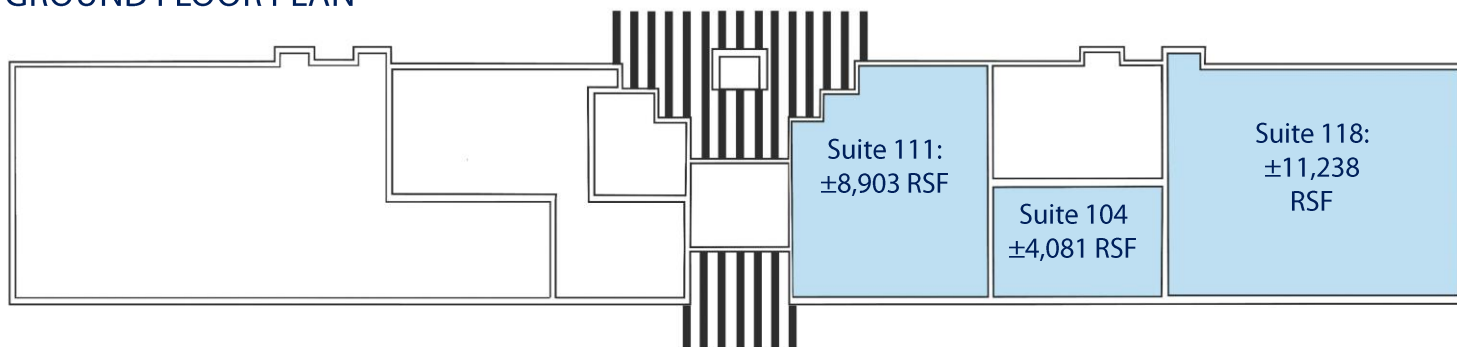

**SECOND FLOOR PLAN**

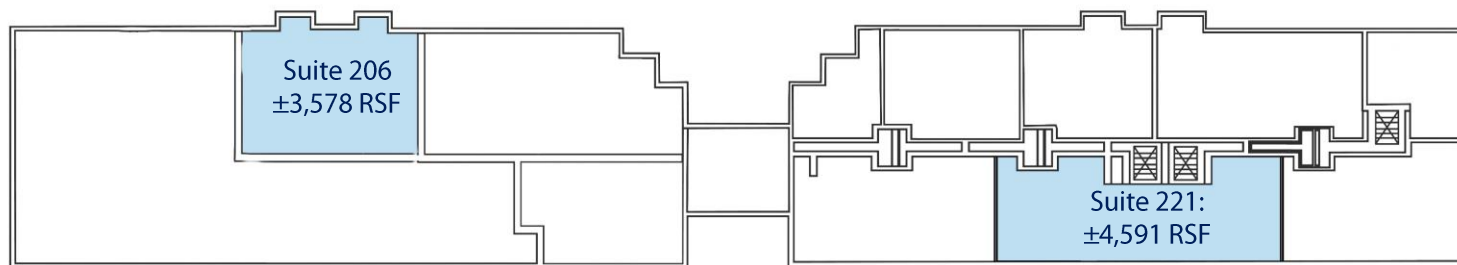

**Andrew Berk**

323.603.5075  
andrew.berk@avisonyoung.com  
DRE License #01369568

**Mark Evanoff**

323.851.6666  
markevanoff@avisonyoung.com  
DRE License #00898650